



COUNTY OF SAN JOAQUIN

DEPARTMENT OF PUBLIC WORKS
P.O. BOX 1810-1810 E. HAZELTON AVENUE
STOCKTON, CALIFORNIA 95201
(209) 468-3000
FAX # (209) 468-9324

Permit No: PS-1602693
Date Issued: 08/29/2016
Start Date: 09/23/2016
Exp. Date: 09/23/2016
Project No: PWP110005
Quad: NE

ENCROACHMENT PERMIT

To: LINDEN HIGH SCHOOL
18527 E. FRONT ST.
LINDEN, CA 95236

Encroachment Type:

TEMP. ROAD CLOSURE			
--------------------	--	--	--

Location:

BOTH SIDES OF FRONT ST. FROM DUNCAN RD. TO ST. HWY 26. HOURS OF CLOSURE WILL BE FROM 1:30 P.M. TO 3:00 P.M. ON 9/23/2016.

In compliance with your request of 08/29/2016, permission is hereby granted to do work in County right-of-way as shown on attached application and subject to all the terms, conditions and restrictions written below or printed as general or special provisions on any part of this form. See reverse side and attached sheet, if any.

Trench excavations for service connections will not be permitted within ten feet (10') of pavement centerline unless otherwise approved by the Director. Surface of trench patches shall match in kind and be smooth and even with that of abutting surface. Special attention shall be given to depth of utilities through roadside area in anticipation of future drainage facilities, road profile and/or frontage development. All underground utility facilities are to be established and accurately dimensioned on sketches from surveyed centerline of road right of way, or from right of way (border) lines.

Permittee shall call the Department of Public Works, Field Engineering Division (Permit Inspections) at (209)953-7421 at least forty-eight hours prior to beginning any work within the County right of way. All work performed under this permit shall conform to the rules and regulations pertaining to safety established by the California Division of Industrial Safety and Cal-OSHA.

The jobsite shall be kept in a safe condition at all times by the daily removal of any excess dirt or debris which might be a hazard to either pedestrian or automobile traffic. All necessary traffic convenience and warning devices and personnel shall be provided, placed and maintained by and at the sole expense of the Permittee in accordance with the latest edition of the CALTRANS Manual of Traffic Control.

After completion of the work permitted herein, all debris, lumber, barricades, or any excess material shall be removed and the jobsite left in a neat workmanlike manner. Immediately following completion of construction permitted herein, Permittee shall fill out and mail notice of completion (see attached post card) provided by Grantor.

Special Comments:

Traffic Control per MUTCD*****Homecoming Parade*****

FORMS:

--	--	--

Est. Permit Fee: \$0.00

WHITE	-Permittee
GOLDENROD	-PWD Central File
YELLOW	-Field Inspection
PINK	-Permit Section

KRIS BALAJI, Director
Department of Public Works

By: 
Permit Section

ENCROACHMENT PERMIT GENERAL PROVISIONS

13-1.

1. This permit is issued under and subject to all laws and ordinances of agencies governing the encroachment herein permitted. See the following references:

STREETS AND HIGHWAYS CODE

1. Division 1, Chapter 3
2. Division 2, Chapter 2, Section 942
3. Division 2, Chapter 4, Section 1126
4. Division 2, Chapter 5.5 and Chapter 6

SAN JOAQUIN COUNTY ORDINANCES NUMBERED: 324, 441, 648, 662, 672, 695, 700, 860, 892, 3359, and 3675.

2. It is understood and agreed by the Permittee that the performance of any work under this permit shall constitute an acceptance of all the provisions contained herein and failure on the Permittee's part to comply with any provision will be cause for revocation of this permit. Except as otherwise provided for public agencies and franchise holders, this permit is revocable on five days notice.
3. All work shall be done subject to the supervision of and the satisfaction of the grantor. The Permittee shall at all times during the progress of the work keep the County Highway in as neat and clean condition as is possible and upon completion of the work authorized herein, shall leave the County Highway in a thoroughly neat, clean and usable condition.
4. The Permittee also agrees by the acceptance of this permit to properly maintain any encroachment structure placed by the Permittee on any part of the County Highway and to immediately repair any damage to any portion of the highway, which occurs as a result of the maintenance of the said encroachment structure, until such time as the Permittee may be relieved of the responsibility for such maintenance by the County of San Joaquin.
5. The Permittee also agrees by the acceptance of this permit to make, at its own expense, such repairs as may be deemed necessary by the County Department of Public Works.
6. It is further agreed by the Permittee that whenever construction, reconstruction or maintenance work upon the highway is necessary, the installation provided for herein shall, upon request of the County Department of Public Works, be immediately moved or removed by and at the sole expense of the Permittee.
7. No material used for fill or backfill in the construction of the encroachment shall be borrowed or taken from within the County right of way.
8. All work shall be planned and carried out with as little inconvenience as possible to the traveling public. No material shall be stacked within eight feet (8') of the edge of the pavement or traveled way unless otherwise provided herein. Adequate provision shall be made for the protection of the traveling public. Traffic control standards shall be utilized including barricades; approved signs and lights; and flagmen, as required by the particular work in progress.
9. The Permittee, by the acceptance of this permit, shall assume full responsibility for all liability for personal injury or damage to property which may arise out of the work herein permitted or which may arise out of the failure of the part of the Permittee to properly perform the work provided under this permit. In the event any claim of such liability is made against the County of San Joaquin or any department, official or employee thereof, the Permittee shall defend, indemnify, and hold each of them harmless for such claim.
10. All backfill material is to be moistened as necessary and thoroughly compacted with mechanical means. If required by the County Director of Public Works, such backfill shall consist of gravel or crushed rock. The Permittee shall maintain the surface over structures placed hereunder as may be necessary to insure the return of the roadway to a completely stable condition and until relieved of such responsibility by the County Department of Public Works. Wherever a gravel, crushed rock or asphalt surface is removed or damaged in the course of work related to the permitted encroachment, such material shall either be separately stored and replaced in the roadway as nearly as possible in its original state or shall be replaced in kind, and the roadway shall be left in at least as good a condition as it was before the commencement of operations of placing the encroachment structure.
11. Whenever it becomes necessary to secure permission from abutting property owners for the proposed work, such authority must be secured by the Permittee prior to starting work.
12. The current and future safety and convenience of the traveling public shall be given every consideration in the location and methods of construction utilized.
13. The Permittee is responsible for the preservation of survey monuments located within the area of work herein permitted. Prior to the start of construction, survey monuments that potentially may be disturbed shall be located and referenced by a Licensed Land Surveyor, and a Corner Record filed with the County Surveyor. Any Survey Monuments disturbed during the course of construction shall be reestablished by a Licensed Land Surveyor and another Corner Record filed with the County Surveyor. (Land Surveyors' Act Section 8771)
14. Prior to any excavation, the Permittee shall notify USA North (Underground Service Alert of Northern California and Nevada) at 811 or 800-227-2600 forty-eight (48) hours in advance.

SPECIAL CONDITIONS FOR
LINDEN HOMECOMING PARADE
ENCROACHMENT PERMIT

1. Traffic control shall be in accordance with the attached traffic handling plan.
2. The traffic handling at designated intersections shall be provided by either California Highway Patrol or the San Joaquin County Sheriff Department. Applicant shall provide the County written verification from either entity prior to the event, by letter or email, confirming their involvement.
3. Delays to the travelling public and local residents shall be kept to a minimum.
4. Residents shall be notified in writing, as approved by the County two weeks prior to the event. Provide a copy of the outreach documents to the County prior to the event.
5. Applicant shall notify and coordinate with all emergency services (fire, police, etc.) and the local postmaster a minimum of seven days prior to the event. Provide written verification to the County, prior to the event, from each entity by letter or email. Applicant shall fax Lifecom (209-236-8701) a description letter of the event with the date and time and a list of affected roads and provide the "sent" fax transmittal as verification.
6. Event signage shall include directions to designated parking locations.
7. Emergency vehicle and local resident access shall be provided at all times.
8. A certificate of insurance, naming San Joaquin County as additional insured and certificate holder, must be submitted to the County prior to the event.
9. Marking of pavement (e.g. paint) is not allowed.
10. Roadway shall be completely cleared and open to the travelling public by 3:00 pm. All related signage shall be removed by 3:15 pm.

APPLICATION FOR ENCROACHMENT PERMIT

PLEASE PRINT:

Date 8/2/2016

To: San Joaquin County
Department of Public Works

Linden High School
(Applicant Name)

18527 E. Front St.
(Mailing Address)

Linden, CA 95236
(City, State, Zip Code)

(209) 881-3073
(Area Code - Telephone Number)

OFFICE USE ONLY			
JOB #	<u>110005</u>	REF #	
APN		CR #	
EXP. DATE	<u>9/23/16</u>		
VALID	<u>9/23/16</u> TO <u>9/23/16</u>		
STREET	<u>FRONT ST.</u>	DRIVEWAYS:	
AREA	<u>LINDEN</u> QUAD <u>NE</u>	*	
TYPE	<u>TEMP. ROAD CLOSURE</u>	*	
FORMS		*	
NOTES	<u>*LINDEN HOMECOMING PARADE*</u> <u>FRIDAY, SEPT. 23, 2016 - 1:30 PM - 3:00 PM.</u>		

Sketch (Detailed plans may be submitted)

See attached map

The undersigned hereby applies for permission to excavate, construct and/or otherwise encroach on County Highway Right-of-Way on the _____ side of _____ approximately _____ feet/mile by performing the following work (description of work):
To close Front Street between Duncan Road and State Highway 26 on September 23, 2016 from 1:30 pm to 2:45 pm.

Work will commence on or about September 23, 2016 for approximately one (1) days.

I, the undersigned, certify that I am the owner of the respective property, or am qualified to represent the owner and agree to do the work described above in accordance with the rules and regulations of San Joaquin County and subject to inspection and approval.

Signature of Applicant - Title

Linden High School Parade Committee

Date

8/2/2016

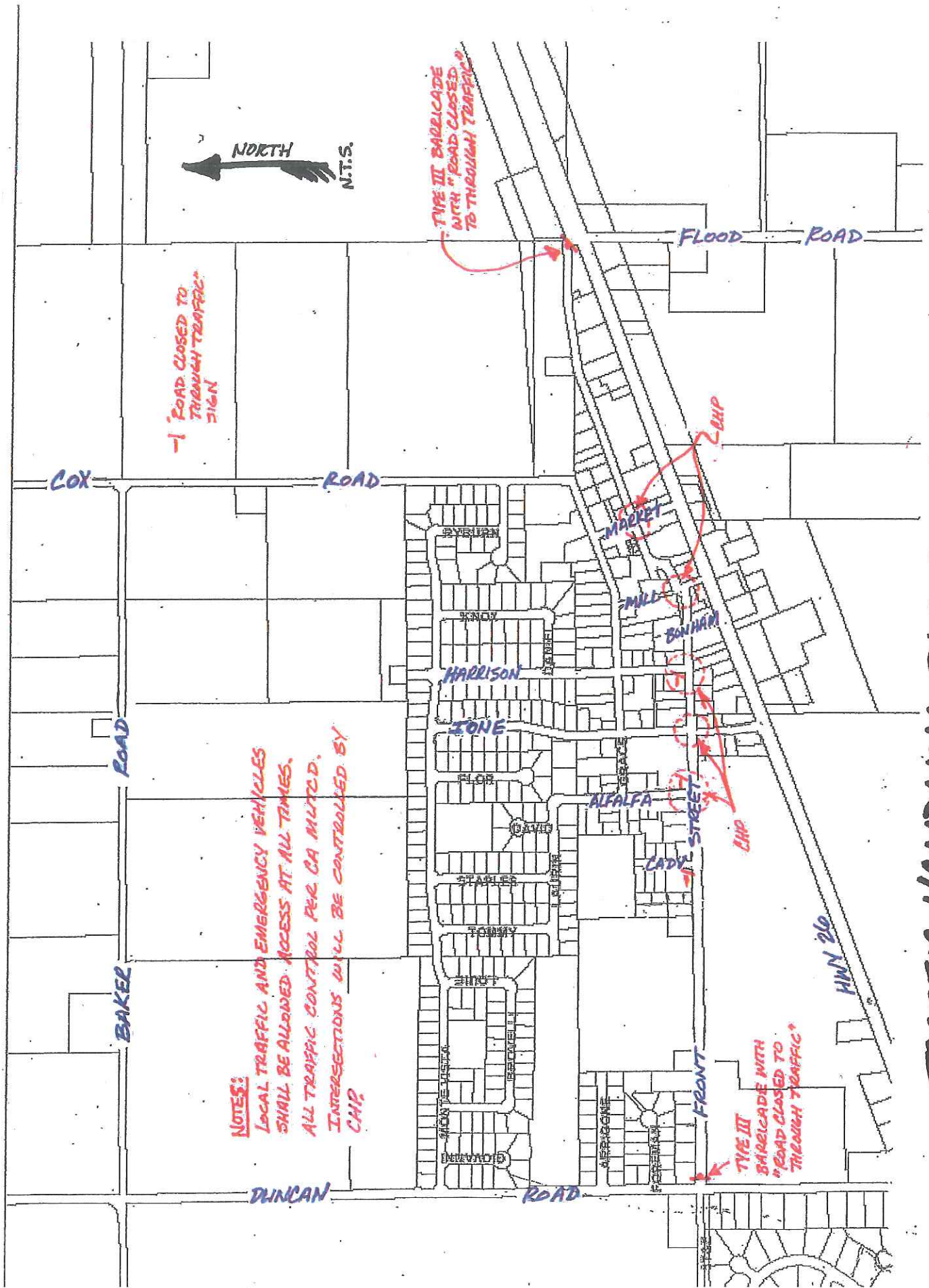

TRAFFIC HANDLING PLAN

Northern California ReLiEF Protected Insurance Program for Schools		CERTIFICATE OF COVERAGE		Issue Date 8/22/2016	
ADMINISTRATOR: Keenan & Associates 1740 Technology Drive, Suite 300 San Jose, CA 95110 408-441-0754 www.keenan.com		LICENSE # 0451271		THIS CERTIFICATE IS ISSUED AS A MATTER OF INFORMATION ONLY AND CONFERS NO RIGHTS UPON THE CERTIFICATE HOLDER. THIS CERTIFICATE DOES NOT AMEND, EXTEND OR ALTER THE COVERAGE AFFORDED BY THE COVERAGE DOCUMENTS BELOW.	
COVERED PARTY: Linden Unified School District San Joaquin Co. Schools P&L Ins. Group 18527 East Main Street Linden CA 95236		ENTITIES AFFORDING COVERAGE: ENTITY A: Northern California ReLiEF ENTITY B: Protected Insurance Program for Schools ENTITY C: ENTITY D: ENTITY E:			
THIS IS TO CERTIFY THAT THE COVERAGES LISTED BELOW HAVE BEEN ISSUED TO THE COVERED PARTY NAMED ABOVE FOR THE PERIOD INDICATED, NOTWITHSTANDING ANY REQUIREMENT, TERM OR CONDITION OF ANY CONTRACT OR OTHER DOCUMENT WITH RESPECT TO WHICH THIS CERTIFICATE MAY BE ISSUED OR MAY PERTAIN. THE COVERAGE AFFORDED HEREIN IS SUBJECT TO ALL THE TERMS AND CONDITIONS OF SUCH COVERAGE DOCUMENTS.					
ENT LTR	TYPE OF COVERAGE	COVERAGE DOCUMENTS	EFFECTIVE/ EXPIRATION DATE	MEMBER RETAINED LIMIT / DEDUCTIBLE	LIMITS
A	GENERAL LIABILITY <input checked="" type="checkbox"/> GENERAL LIABILITY <input checked="" type="checkbox"/> CLAIMS MADE <input checked="" type="checkbox"/> GOVERNMENT CODES <input checked="" type="checkbox"/> ERRORS & OMISSIONS	NCR 00801-23	7/1/2016 7/1/2017	\$ 50,000	COMBINED SINGLE LIMIT EACH OCCURRENCE \$ 1,000,000
A	AUTOMOBILE LIABILITY <input checked="" type="checkbox"/> ANY AUTO <input checked="" type="checkbox"/> HIRED AUTO <input checked="" type="checkbox"/> NON-OWNED AUTO <input checked="" type="checkbox"/> GARAGE LIABILITY <input checked="" type="checkbox"/> AUTO PHYSICAL DAMAGE	NCR 00801-23	7/1/2016 7/1/2017	\$ 50,000	COMBINED SINGLE LIMIT EACH OCCURRENCE \$ 1,000,000
A	PROPERTY <input checked="" type="checkbox"/> ALL RISK <input checked="" type="checkbox"/> EXCLUDES EARTHQUAKE & FLOOD <input type="checkbox"/> BUILDER'S RISK	NCR 00801-23	7/1/2016 7/1/2017	\$ 25,000	\$ 250,250,000 EACH OCCURRENCE
A	STUDENT PROFESSIONAL LIABILITY	NCR 00801-23	7/1/2016 7/1/2017	\$ 50,000	\$ Included EACH OCCURRENCE
B	WORKERS COMPENSATION <input checked="" type="checkbox"/> EMPLOYERS' LIABILITY	PIPS12713	7/1/2016 7/1/2017	\$	<input type="checkbox"/> WC STATUTORY LIMITS <input checked="" type="checkbox"/> OTHER \$ 1,000,000 E.L. EACH ACCIDENT
	EXCESS WORKERS COMPENSATION <input type="checkbox"/> EMPLOYERS' LIABILITY			\$	\$ 1,000,000 E.L. DISEASE - EACH EMPLOYEE \$ 1,000,000 E.L. DISEASE - POLICY LIMITS
	OTHER			\$	
DESCRIPTION OF OPERATIONS/LOCATIONS/VEHICLES/RESTRICTIONS/SPECIAL PROVISIONS: As respects to the closure of Front Street between Duncan Road and Highway 26 in Linden, California for the Homecoming Parade by participating Linden High School on September 23, 2016 from 1:30 p.m. to 2:45 p.m..					
CERTIFICATE HOLDER: Linden HS Homecoming Parade San Joaquin County Attn: Risk Manager P.O. Box 1810 Stockton CA 95210			CANCELLATION..... SHOULD ANY OF THE ABOVE DESCRIBED COVERAGES BE CANCELED BEFORE THE EXPIRATION DATE THEREOF, THE ISSUING ENTITY/JPA WILL ENDEAVOR TO MAIL 30 DAYS WRITTEN NOTICE TO THE CERTIFICATE HOLDER NAMED TO THE LEFT, BUT FAILURE TO MAIL SUCH NOTICE SHALL IMPOSE NO OBLIGATION OR LIABILITY OF ANY KIND UPON THE ENTITY/JPA, ITS AGENTS OR REPRESENTATIVES.		
			 John Stephens AUTHORIZED REPRESENTATIVE		

ENDORSEMENT

ADDITIONAL COVERED PARTY

COVERED PARTY	COVERAGE DOCUMENT	ADMINISTRATOR
Linden Unified School District San Joaquin Co. Schools P&L Ins. Group	NCR 00801-23	Keenan & Associates

Subject to all its terms, conditions, exclusions, and endorsements, such additional covered party as is afforded by the coverage document shall also apply to the following entity but only as respects to liability arising directly from the actions and activities of the covered party described under "as respects" below.

Additional Covered Party:

San Joaquin County
Attn: Risk Manager
P.O. Box 1810
Stockton CA 95210

As Respects:

As respects to the closure of Front Street between Duncan Road and Highway 26 in Linden, California for the Homecoming Parade by participating Linden High School on September 23, 2016 from 1:30 p.m. to 2:45 p.m..



Authorized Representative

Issue Date: 8/22/2016



Enter to Learn...
Leave to Achieve

Linden Unified School District

18527 E. Main Street
Linden, CA 95236
(209) 887-3894 FAX (209) 887-2250
www.lindenUSD.com

Governing Board

Jay Colombini
Teri Dondoro
Kirstin Holtberg
John Huber, Jr.
Denise Moore
Eric Nims
Clayton Titus

Administration

Rick Hall
Superintendent

Dmitriy Voloshin
Director of Educational
Services

Gina Murphy-Garrett
Chief Business Officer

Event Description Letter

Monday, August 22nd, 2016

Dear San Joaquin County Department of Public Works,

Linden High School is submitting an application for an encroachment permit for our annual Homecoming Parade on Friday, September 23rd. The parade will be on Front Street in Linden and will begin at 2:00 p.m. and will begin on the corner of Market Street and end on the corner of Duncan Road. There will be approximately 300 participants in the parade.

Thank you,

Eric Weber
Linden High School
Activities Director